

# How to Install Your Vinyl Graphics

## Tools Needed:

- Plastic Squeegee, credit card or driver's license.
- Tape Measure or Ruler
- Masking Tape (1" or wider)
- Marking Pen or Pencil
- Lint-free paper towels
- Surface Cleaner (409, Windex, Soap & Water)

## Surface Preparation:

Before installing any graphics, you must clean the surface on which the decal will be applied to. Using a soft cloth, wash the surface thoroughly. Residual grease, soot or tar should be further cleaned with a solvent. Be sure to clean the surface several times if it was extremely dirty when you started. To avoid adhesion problems, be sure that all liquid has completely dried from under vehicle panel seams and around rivet heads. The surface you are applying the decals to **MUST** be in a 60 to 85 degree Fahrenheit environment. If it is too cold the adhesive will not work. If it is too hot the vinyl becomes extremely flexible which makes it very difficult and at times, impossible to apply.

## Installation Procedures:

- 1 Clean the surface.**  
Use a dry cloth to clean the surface.



- 2 Secure with tape.**  
Tape the vinyl graphic in place and measure from multiple vantage points to ensure that it is positioned symmetrically.



- 3 Tape in place.**  
Once you are satisfied with the position, apply another piece of tape across the top of the vinyl graphic.

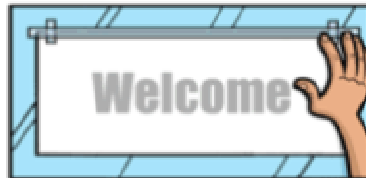

- 4 Remove backing paper.**  
With the tape functioning as a hinge, flip the vinyl graphic around and carefully remove the backing paper from the transfer tape.

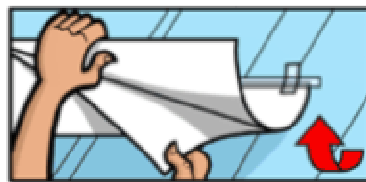

- 5 Apply the graphic.**  
With the graphic in place, apply pressure with a credit card. Working from the center to the edge, evenly force the air from beneath the image.



- 6 Remove Transfer tape.**  
Remove the tape from the top of the graphic. Now carefully peel away the transfer tape.

